

改修 PH階平面図 S=1:200

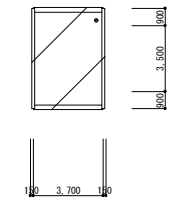

改修 PH階屋根状図 S=1:200

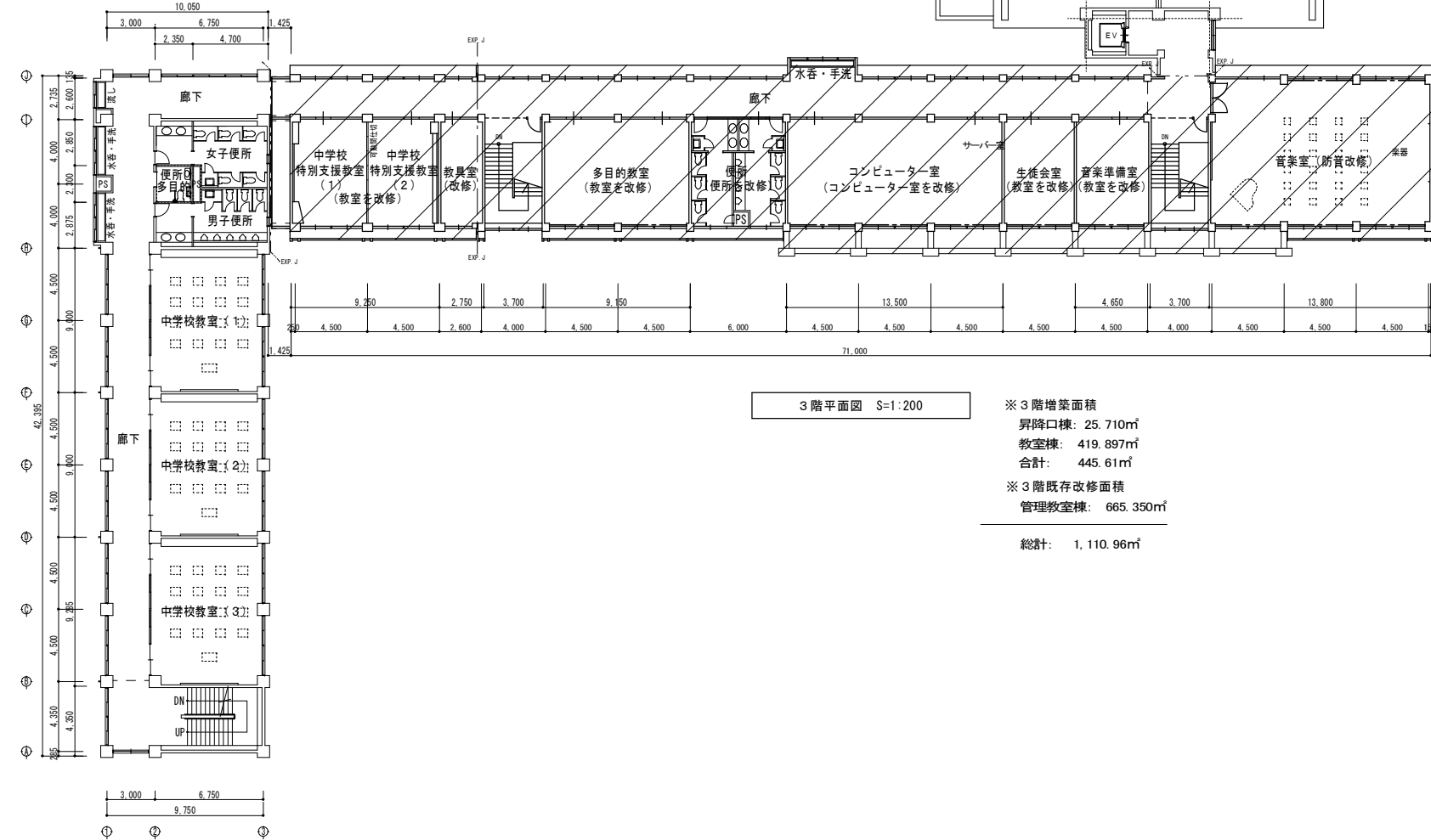
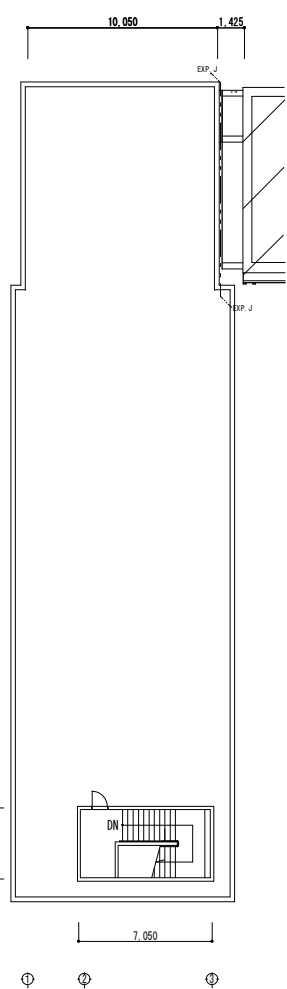
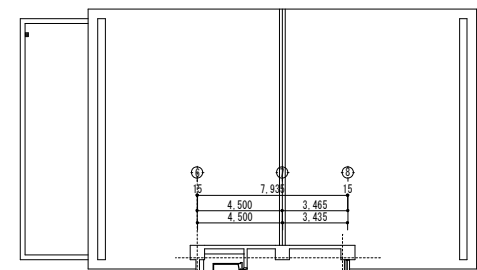
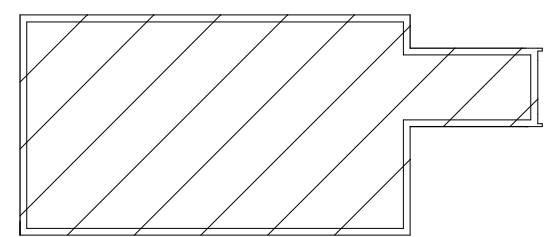

3階平面図 S=1:200

※3階増築面積  
 昇降口棟: 25.710㎡  
 教室棟: 419.897㎡  
 合計: 445.61㎡  
 ※3階既存改修面積  
 管理教室棟: 665.350㎡  
 総計: 1,110.96㎡

